



## Glamping / Camping Pod BRETA (44 mm), 4x6 m (13'x20'), 24 m<sup>2</sup>

Product #AV2341

- Interchange the opposite walls!
- Premium windows & doors
- Tongue & Groove floorboards included
- Hardware kit included
- Window and door seals included
- Storm braces included
- Pure glass – no cheap plastic
- Reliable floor bearers
- Polite & Convenient delivery
- Made while protecting the forests
- Better resistance to rot & mould
- Moisture resistant door and windows
- Reinforced roof construction
- Secure locks & hinges
- Direct from the factory

**£6,406.00**

~~£6,532.00~~ / You save £126.00

### The price includes:

wooden building kit (walls, roof, floor),  
double glazed wooden doors &  
windows, hardware kit, delivery,  
offloading, VAT.

Visit our website to make sure this is  
the current price:

<https://www.quick-garden.co.uk/glamping-camping-pod-breta-44mm-4-x-6-m-13-x-20-24-m2.html>



**Finance available. Contact us!**

## Specifications & detailed sketches

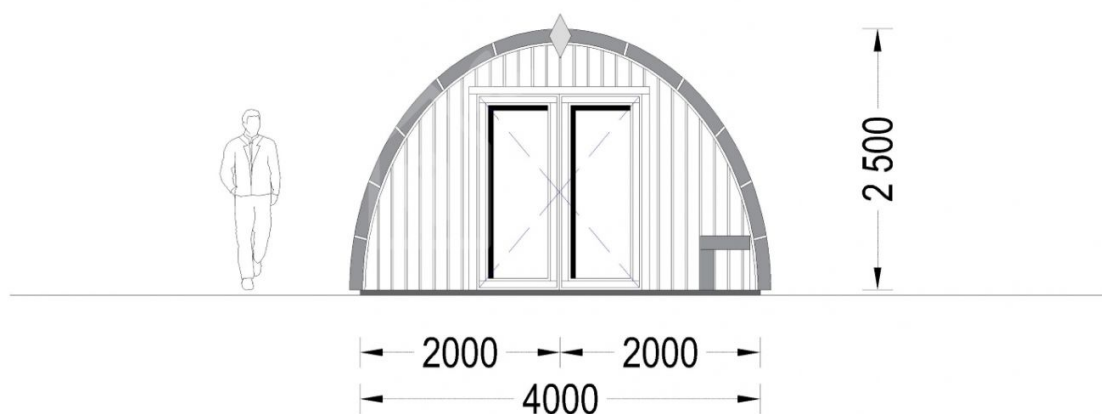
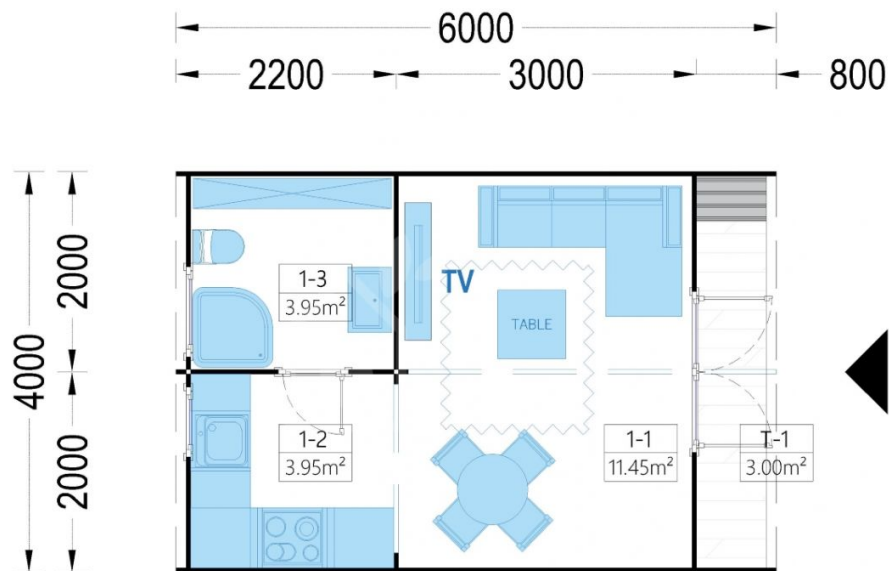

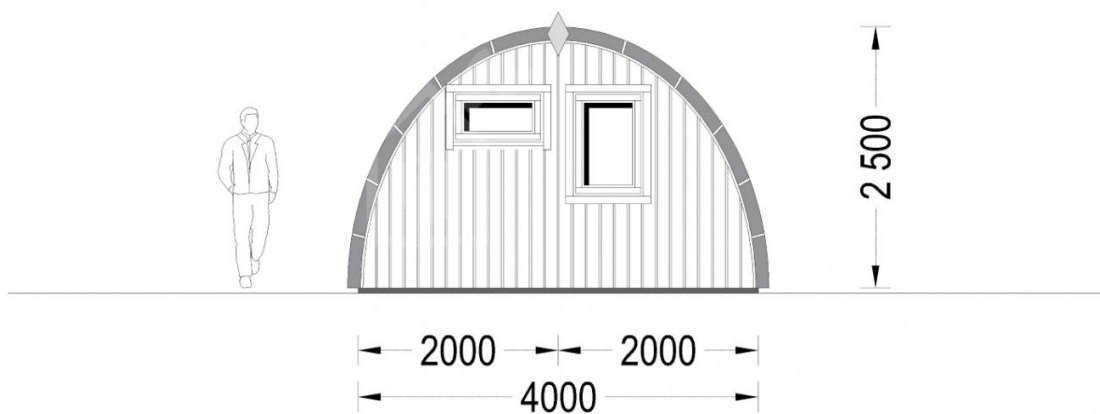
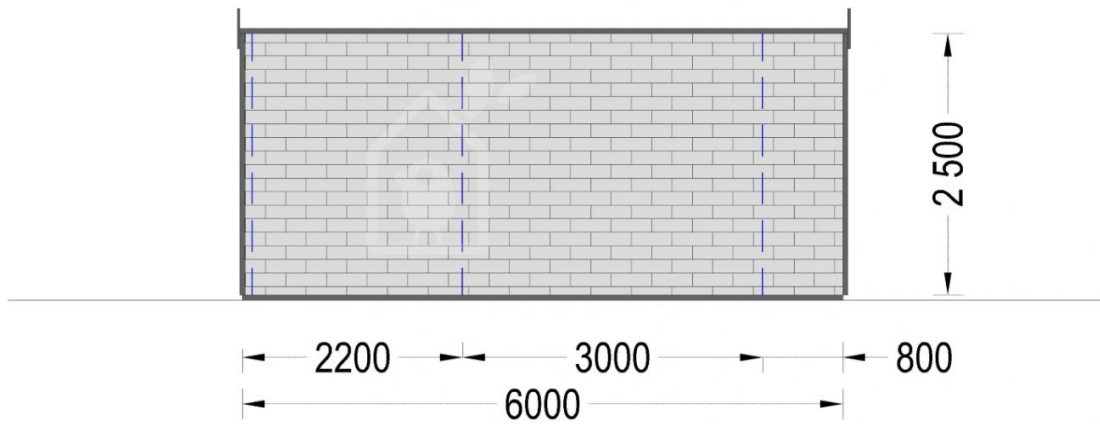

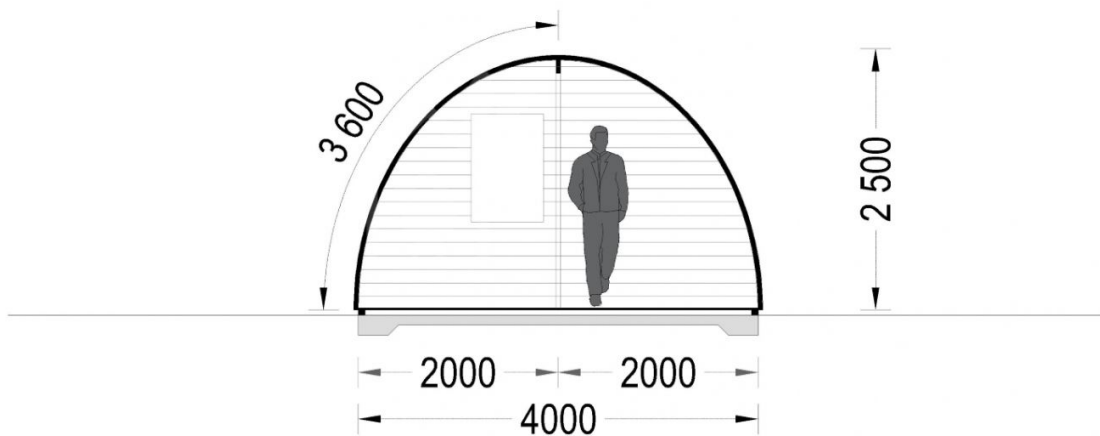
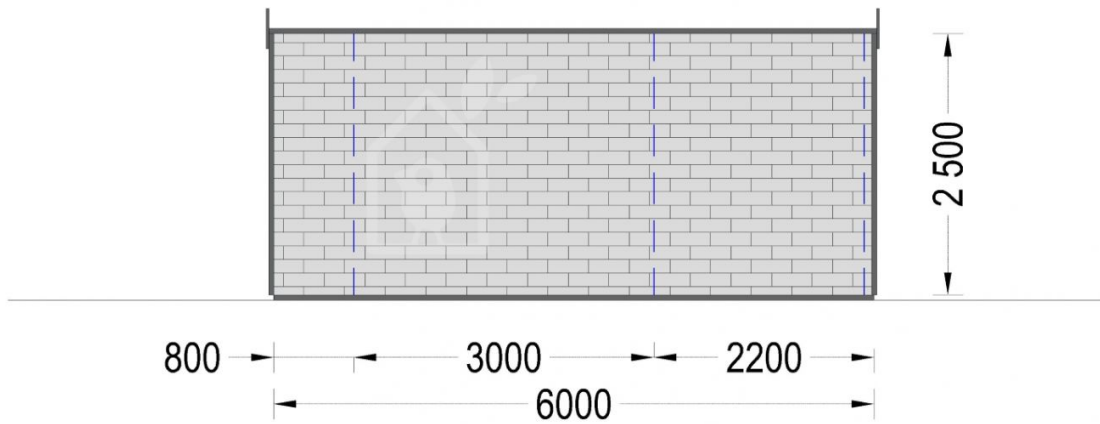

## Product specifications

Material	Slow grown spruce
Doors	1* 161 cm x 192cm, 1* 70 cm x 192 cm
Floor area	24 m <sup>2</sup>
Windows	1* 70 cm x 105 cm, 1* 90cm x 39 cm
Ridge Height	250 cm
Roof	44 mm thick tongue & groove boards
Roof Overhang (Front, Side, Back)	60 cm
Floor	19 - 20 mm thick tongue & groove boards
Wall	44 mm
Wood Treatment	Optional
Anti Rot Warranty	10 Year
Total Number of Rooms	3
Roof Covering Material	Optional
External dimensions (WxD), Metric	400 x 600 cm

## Select product features according to your needs

TIKKURILA Ultra Classic paints	White	+£161.00
	Yellow	+£223.00
	Clear	+£97.00
	Brown	+£169.00
Bitumen roofing shingles + underlay	Red Shingles	+£765.00
	Green Shingles	+£765.00
	Black Shingles	+£765.00
25 mm Roof & Floor insulation		+£673.00
Clear water-based primer for interior		+£210.00
PVC windows & doors (White)		+£2,351.00
PVC windows & doors (Anthracite)		+£2,936.00

Timber frame base	With metal ground screws (4.0x5.9m)	+£1,957.00
	With PVC pedestals (4.0x5.9m)	+£1,237.00
Woodshed 2.2m x 1.44m		From +£599.00
Vinyl flooring	Grey	+£1,176.00
	Oak	+£1,176.00

## Customer Service

### Free delivery \*

Mainland England and Wales

4 - 8 working days for products in stock

4 - 8 weeks for products not in stock or custom-made products

Mainland Scotland

8 - 15 working days for products in stock

4 - 8 weeks for products not in stock or custom-made products

\* An extra charge for deliveries to mainland Scotland applies only for items which are priced under £3000. In such cases you will find these charges on each product page. For all items whose price is over £3000, delivery to mainland Scotland is free of charge.

---

### Payment

We accept card and bank payments.

To submit your order, you can either choose to pay a deposit of 20% of the total price or to pay the whole price in one go.

---

### Planning permission

Contact us for any advice you may need regarding basic planning permission or building regulation matters. We will always be happy to help you.

---

### 10 yrs. warranty

All garden buildings with a wall thickness of at least 34mm come with a 10-year anti-rot guarantee. Structures with 28mm wall thickness come with a corresponding 5-year anti-rot guarantee.